

SIGMABELT

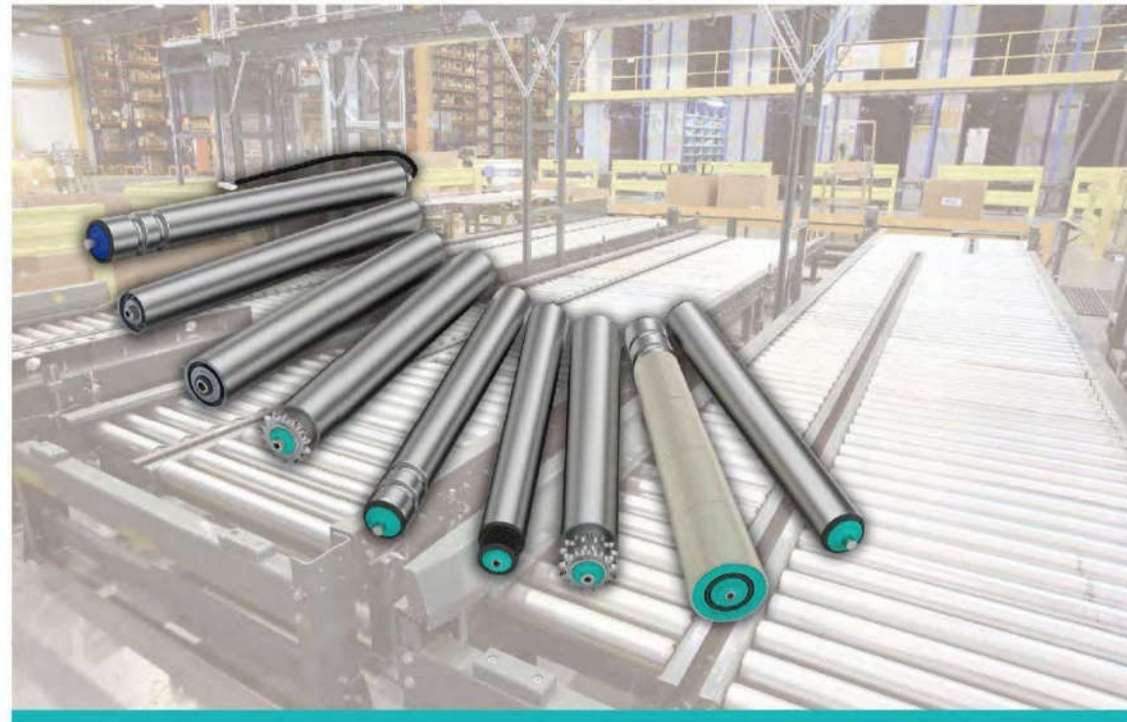

SIGMABELT

Tel: +7(812)426-17-48

E-mail: info@sigmabelt.ru

CONVEYOR ROLLER PRODUCTS OVERVIEW

www.sigmabelt.ru

1200 Series

Universal Conveyor Roller

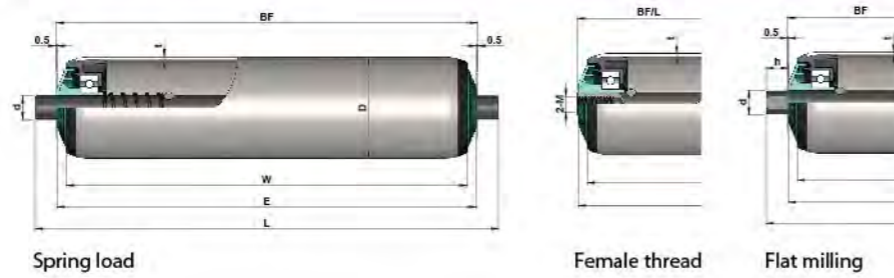

- Design of polymer bearing housing and end cap
- Beautiful, quiet operation
- Many options of tube and installation type
- Wide application, Max speed up to 120m/min

D	t	Bearing	Shaft	Tube			
				Steel Z/P	SS	Aluminium	PVC
Φ38	1.2	6002	11hex, Φ8, 10, 12	✓	✓		
Φ48.6	1.5	6002	11hex, Φ8, 10, 12	✓	✓		
Φ50	1.5	6002	11hex, Φ8, 10, 12, 15	✓	✓	✓	
Φ50	2	6002	11hex, Φ8, 10, 12, 15	✓	✓		
Φ50	2.5	6002	11hex, Φ8, 10, 12, 15				✓
Φ60	2	6002	11hex, Φ8, 10, 12, 15	✓	✓	✓	
Φ60	3	6003	Φ17	✓			
Φ80	3	6205	Φ20	✓			

Remark: 2mm PVC sleeve for Φ50 tube, Shaft Dia. 15 is not available for spring load.



- Steel bearing housing, precision bearing, sturdy and durable
- Many options of diameter, wide range of load capacity
- Could apply in high speed and conditions of -10~80°C

1800 Series

Gravity Roller

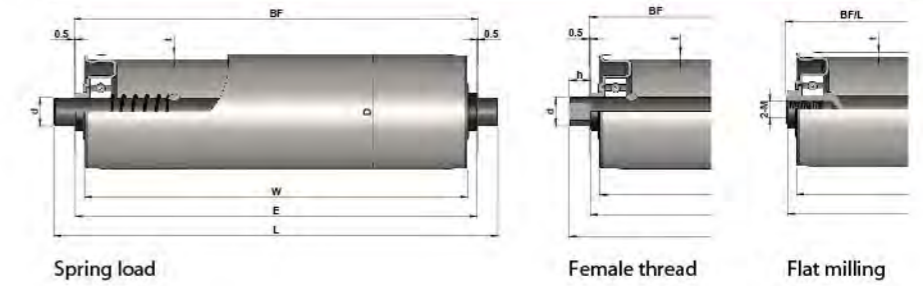

D	t	Bearing	Shaft	Tube		
				Steel Z/P	SS	Aluminium
Φ38	1.2	6001	Φ12	✓	✓	
Φ38	1.5	6001	Φ12			✓
Φ50	1.5	6001, 6002	Φ12, 15	✓	✓	✓
Φ50	2	6001, 6002	Φ12	✓		
Φ60	2	6001, 6202	Φ12, 15	✓	✓	✓
Φ60	3	6202	Φ15	✓		
Φ76	3	6202, 6204	Φ15, 20	✓	✓	✓
Φ76	4	6204	Φ20	✓		
Φ80	2	6204	Φ20	✓		
Φ80	3	6204	Φ20	✓		
Φ80	4	6204	Φ20			✓
Φ89	3	6204	Φ20	✓		
Φ89	4	6204	Φ20	✓		

Remark: 2mm PVC sleeve for Φ50 tube.

1100 Series

Light, Middle Duty Conveyor Roller

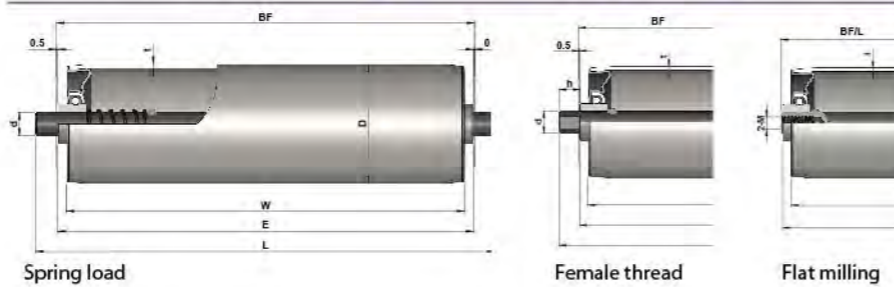

- Special semi-precision bearing
- Suitable for gravity or gliding conveyor

D	t	Bearing	Shaft	Tube		
				Steel Z/P	SS	Aluminium
Φ25	1	Semi precision bearing	Φ6, 8	✓		✓
Φ38	1.2	Semi precision bearing	Φ12	✓	✓	
Φ50	1.5	Semi precision bearing	Φ8, 12	✓	✓	✓
Φ60	2	Semi precision bearing	Φ12	✓		✓



- Polymer ball bearing
- PVC tube, with good chemical stability
- Very light and smoothly running
- suitable for light duty load

1900 Series

Light Conveyor Roller

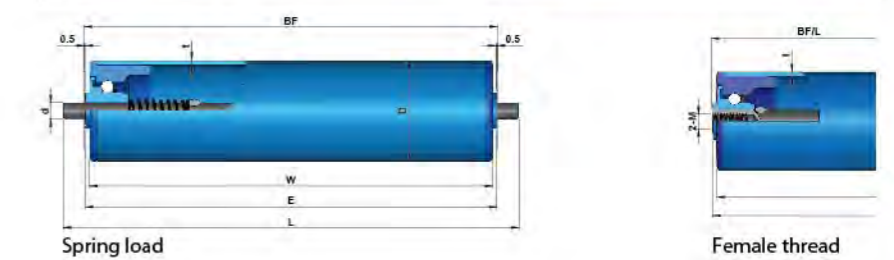

D	t	Bearing	Shaft	Tube
				PVC
Φ20	1.5	polymer ball bearing	Φ6	✓
Φ25	1.8	polymer ball bearing	Φ6, 8	✓
Φ30	1.8	polymer ball bearing	Φ6, 8	✓
Φ38	2	polymer ball bearing	Φ8, 10	✓
Φ50	2.5	polymer ball bearing	Φ8, 10, 12	✓
Φ60	3	polymer ball bearing	Φ12, 15	✓



2240

- Simple structure, groove position customized
- Quiet operation, Standard anti-static design
- Application for light & middle duty

2230/2240 Series

Single/Double groove
O-belt Conveyor Roller

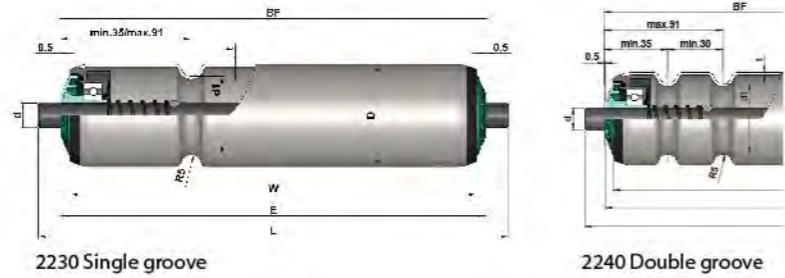

D	t	Bearing	Shaft	Tube	
				Steel Z/P	SS
Φ38	2	6002	11hex, Φ8,10,12,	√	
Φ48.6	1.5	6002	11hex, Φ8,10,12, 15	√	
Φ50	1.5	6002	11hex, Φ8,10,12, 15	√	√
Φ50	2	6002	11hex, Φ8,10,12, 15	√	
Φ60	2	6002	11hex, Φ8,10,12, 15	√	√

Remark: 2mm PVC sleeve for Φ50 tube. Shaft Dia. 15 is not available for springload.

2250 Series

Poly-Vee Roller



- High speed, quiet operation same as O-Belt roller
- 9 V-grooves, more options of PJ poly-Vee belt
- Higher transport efficiency

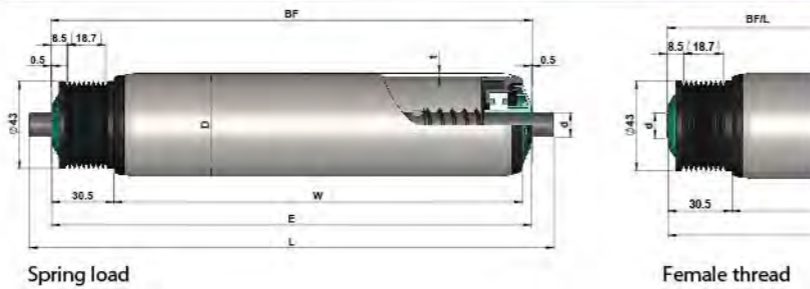

D	t	Bearing	Shaft	Tube	
				Steel Z/P	SS
Φ48.6	1.5	6002	11hex, Φ8, 10, 12, 15	√	√
Φ50	1.5	6002	11hex, Φ8, 10, 12, 15	√	√

Remark: 2mm PVC sleeve for Φ50 tube. Shaft Dia. 15 is not available for spring load.



- The end driven, more stabilized conveying
- Based on 1200 series design, beautiful, quiet operation
- Apply in high speed for light & middle duty

2260 Series

O-Belt Wheel Roller

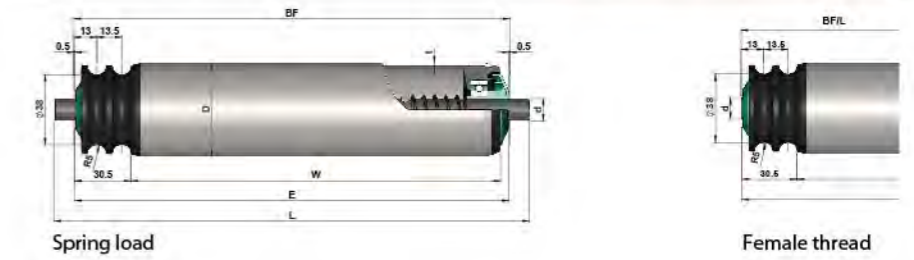

D	t	Bearing	Shaft	Tube	
				Steel Z/P	SS
Φ50	1.5	6002	11hex, Φ8, 10, 12, 15	√	√

Remark: 2mm PVC sleeve for Φ50 tube. Shaft Dia. 15 is not available for spring load.

2214/2224 Series

Single/Double
Polymer Sprocket Roller



2214



2224

- Polymer sprocket design, lighter and quieter
- Self-lubricating with steel chain, completely free of maintenance
- Suitable for light, middle duty convey

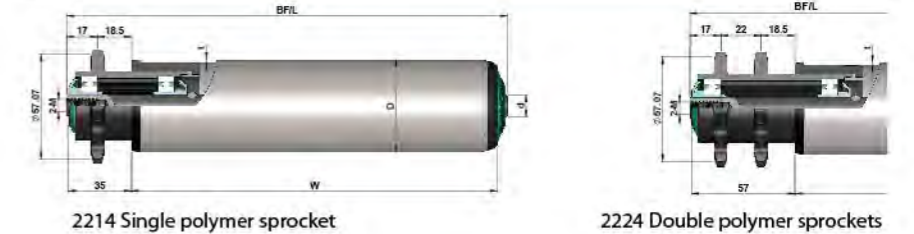

D	t	Bearing	Shaft	Sprocket	Tube			
					Steel Z/P	SS	Aluminium	PVC
Φ50	1.5	6002	Φ12, 15	08B14T	√	√	√	
Φ50	2.5	6002	Φ12, 15	08B14T				√
Φ60	2	6002	Φ12, 15	08B14T	√	√	√	

Remark: 2mm PVC sleeve for Φ50 tube.



2311



2321

- Circle welding of sprocket and tube, steel bearing housing
- High intensity, larger transmit torque, and higher load capacity
- Apply in the condition of -10~80°C

2311/2321 Series

With steel bearing housing
Single/Double Steel Sprocket Roller

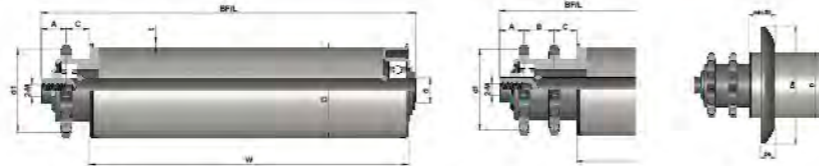

2311 Single steel sprocket 2321 Double steel sprocket Flange

D	t	Bearing	Shaft	Sprocket	Tube	
					Steel Z/P	SS
Φ50	1.5	6001	Φ12	08B11T	√	√
Φ50	2	6001	Φ12	08B11T	√	√
Φ60	2	6001, 6202	Φ12, 15	08B14T	√	√
Φ60	3	6202	Φ15	08B14T	√	√
Φ76	3	6202, 6204	Φ15, 20	10A13T	√	√
Φ76	4	6204	Φ20	10A13T	√	√
Φ80	3	6204	Φ20	10B15T	√	√
Φ89	3	6204	Φ20	10B15T	√	√
Φ89	4	6204	Φ20	10B15T	√	√

Type	D	D1	D2
welding	Φ76	Φ135	20
locked	Φ89	Φ150	20
locked	Φ76	Φ138, 195	23

2411/2421 Series

With polymer bearing housing
Single/Double Steel Sprocket Roller



2411 Single steel sprocket 2421 Double steel sprocket

D	t	Bearing	Shaft	Sprocket	Tube	
					Steel Z/P	SS
Φ50	1.5	6002	Φ12, 15	08B14T	√	√
Φ50	2	6002	Φ12, 15	08B14T	√	√
Φ60	2	6002	Φ12, 15	08B14T	√	√
Φ80	3	6205	Φ20	10B15T	√	√

2411



2421

- Beautiful Polymer bearing housing design
- Lighter and quieter running



3214

3224

- Polymer sprocket and accumulating sleeve, Abrasion resistant and self-lubricating
- Low noise, could switch easily with 2214/2224 series

3214/3224 Series

Accumulating Roller
Single/Double Polymer Sprocket



3214 Single polymer sprocket 3224 Double polymer sprocket

D	t	Bearing	Shaft	Sprocket	Tube		
					Steel Z/P	SS	PVC
Φ50	1.5	6002	Φ12, 15	08B14T	√	√	
Φ50	2.5	6002	Φ12, 15	08B14T			√
Φ60	2	6002	Φ12, 15	08B14T	√	√	



3212

3222

- Size are same as 3214/3224 series
- Steel sprocket is more durable

3211/3221 Series

Accumulating Roller
Single/Double Steel Sprocket

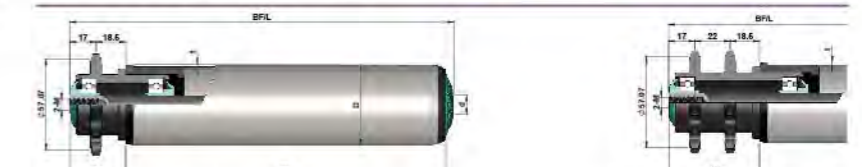

3211 Single steel sprocket 3221 Double steel sprocket

D	t	Bearing	Shaft	Sprocket	Tube	
					Steel Z/P	SS
Φ50	1.5	6002	Φ12, 15	08B14T	√	√
Φ60	2	6002	Φ12, 15	08B14T	√	√

3816/3826 Series

Accumulating Roller
Single/Double Steel Sprocket



3816 Single steel sprocket 3826 Double steel sprocket

D	t	Bearing	Shaft	Sprocket	Tube	
					Steel Z/P	SS
Φ50	1.5	6001	Φ12	08B11T	√	√
Φ60	2	6001, 6002	Φ12, 15	08B14T	√	√
Φ76	3	6204	Φ20	10A13T	√	√



3816

3826

- Special friction slice, well abrasion resistant, long life time, long life time
- Adjustable friction, more accurate and steady convey, wide application

Polymer Taper Roller



- Beautiful, quiet running, easy to clean
- Covered with polypropylene(pp) taper sleeve, modular
- Light weight, easy start-up

1600 Series

Gravity Taper Roller



D	t	Bearing	Shaft	Taper Length
Φ 50	1.5	6002	hex11, Φ12, 15	250
Φ 50	1.5	6002	hex11, Φ12, 15	300
Φ 50	1.5	6002	hex11, Φ12, 15	350
Φ 50	1.5	6002	hex11, Φ12, 15	400
Φ 50	1.5	6002	hex11, Φ12, 15	450
Φ 50	1.5	6002	hex11, Φ12, 15	500
Φ 50	1.5	6002	hex11, Φ12, 15	550
Φ 50	1.5	6002	hex11, Φ12, 15	600
Φ 50	1.5	6002	hex11, Φ12, 15	650
Φ 50	1.5	6002	hex11, Φ12, 15	700
Φ 50	1.5	6002	hex11, Φ12, 15	750
Φ 50	1.5	6002	hex11, Φ12, 15	800
Φ 50	1.5	6002	hex11, Φ12, 15	850

Remark: can provide two kinds of tube: Steel Z/P and SS.



- Light weight, easy start-up
- Quiet running, shockproof and well abrasion resistant
- O-belt drive, grooves position customized
- Suitable for light duty convey

2640 Series

O-belt Taper Roller

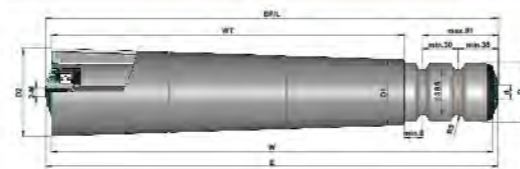

D	t	Bearing	Shaft	Taper Length
Φ 50	1.5	6002	hex11, Φ12, 15	250
Φ 50	1.5	6002	hex11, Φ12, 15	300
Φ 50	1.5	6002	hex11, Φ12, 15	350
Φ 50	1.5	6002	hex11, Φ12, 15	400
Φ 50	1.5	6002	hex11, Φ12, 15	450
Φ 50	1.5	6002	hex11, Φ12, 15	500
Φ 50	1.5	6002	hex11, Φ12, 15	550
Φ 50	1.5	6002	hex11, Φ12, 15	600
Φ 50	1.5	6002	hex11, Φ12, 15	650
Φ 50	1.5	6002	hex11, Φ12, 15	700
Φ 50	1.5	6002	hex11, Φ12, 15	750
Φ 50	1.5	6002	hex11, Φ12, 15	800
Φ 50	1.5	6002	hex11, Φ12, 15	850

Remark: can provide two kinds of tube: Steel Z/P and SS.



- Light weight, easy start-up
- Beautiful and quiet running,
- Polymer sprocket, suitable for middle convey

2650 Series

Poly-Vee Taper Roller

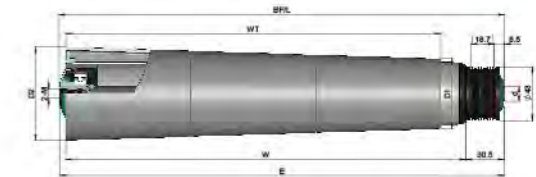

D	t	Bearing	Shaft	Taper Length
Φ 50	1.5	6002	hex11, Φ12, 15	250
Φ 50	1.5	6002	hex11, Φ12, 15	300
Φ 50	1.5	6002	hex11, Φ12, 15	350
Φ 50	1.5	6002	hex11, Φ12, 15	400
Φ 50	1.5	6002	hex11, Φ12, 15	450
Φ 50	1.5	6002	hex11, Φ12, 15	500
Φ 50	1.5	6002	hex11, Φ12, 15	550
Φ 50	1.5	6002	hex11, Φ12, 15	600
Φ 50	1.5	6002	hex11, Φ12, 15	650
Φ 50	1.5	6002	hex11, Φ12, 15	700
Φ 50	1.5	6002	hex11, Φ12, 15	750
Φ 50	1.5	6002	hex11, Φ12, 15	800
Φ 50	1.5	6002	hex11, Φ12, 15	850

Remark: can provide two kinds of tube: Steel Z/P and SS.

2624 Series

Polymer Sprocket Taper Roller

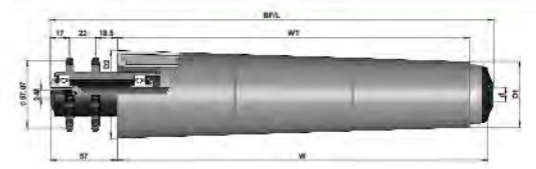

D	t	Bearing	Shaft	Taper Length
Φ 50	1.5	6002	hex11, Φ12, 15	250
Φ 50	1.5	6002	hex11, Φ12, 15	300
Φ 50	1.5	6002	hex11, Φ12, 15	350
Φ 50	1.5	6002	hex11, Φ12, 15	400
Φ 50	1.5	6002	hex11, Φ12, 15	450
Φ 50	1.5	6002	hex11, Φ12, 15	500
Φ 50	1.5	6002	hex11, Φ12, 15	550
Φ 50	1.5	6002	hex11, Φ12, 15	600
Φ 50	1.5	6002	hex11, Φ12, 15	650
Φ 50	1.5	6002	hex11, Φ12, 15	700
Φ 50	1.5	6002	hex11, Φ12, 15	750
Φ 50	1.5	6002	hex11, Φ12, 15	800
Φ 50	1.5	6002	hex11, Φ12, 15	850

Remark: can provide two kinds of tube: Steel Z/P and SS.



- Light weight, easy start-up
- O-belt drive, moving the O-belt to the end of the roller
- Beautiful and quiet running, shockproof and well abrasion resistant
- Suitable for light convey, steady running

2660 Series

O-belt Wheel Taper Roller

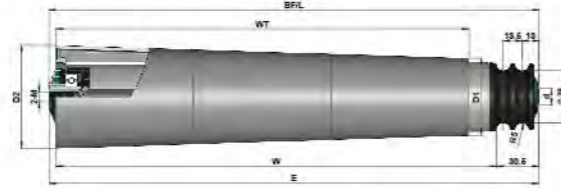

D	t	Bearing	Shaft	Taper Length
Φ 50	1.5	6002	Φ11hex, 12, 15	250
Φ 50	1.5	6002	Φ11hex, 12, 15	300
Φ 50	1.5	6002	Φ11hex, 12, 15	350
Φ 50	1.5	6002	Φ11hex, 12, 15	400
Φ 50	1.5	6002	Φ11hex, 12, 15	450
Φ 50	1.5	6002	Φ11hex, 12, 15	500
Φ 50	1.5	6002	Φ11hex, 12, 15	550
Φ 50	1.5	6002	Φ11hex, 12, 15	600
Φ 50	1.5	6002	Φ11hex, 12, 15	650
Φ 50	1.5	6002	Φ11hex, 12, 15	700
Φ 50	1.5	6002	Φ11hex, 12, 15	750
Φ 50	1.5	6002	Φ11hex, 12, 15	800
Φ 50	1.5	6002	Φ11hex, 12, 15	850

Remark: can provide two kinds of tube: Steel Z/P and SS.

Steel Taper roller



- Steel tube, tight and durable
- Standard 3.6° conical degree, and could be customized
- Suitable for middle convey

1500 Series

Gravity Steel Taper Roller

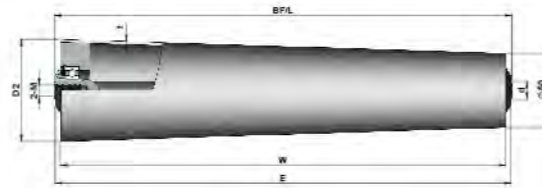

D* (small end)	t	Bearing	Shaft	Taper Length	Tube
Φ50*1.5		6002	Φ12, 15	Customized	Steel, Z/P

2521 Series

Steel Sprocket Tapered Roller

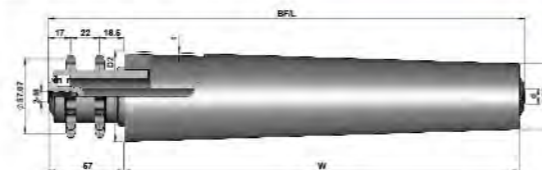

D* (small end)	t	Bearing	Shaft	Taper Length	Tube
Φ50*1.5		6002	Φ12, 15	Customized	Steel, Z/P



- Steel sprocket welded with tube, suitable for middle convey
- Steel tube, tight and durable
- The bearing in the end of the sprocket is dismountable, Higher load capacity
- Standard 3.6° conical degree, and could be customized

Adjustable Foot



BJ-16

BF-20

Floway Wheel Track

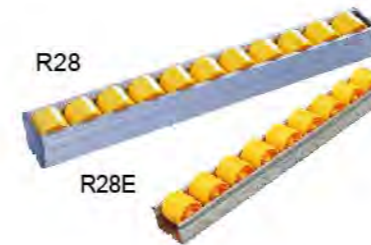

R28

R28E

Series	d	D	H	h	b	d1	Load (kg)
BJ-16	M16	68	148	14	/	/	140
BF-20	M20	120	162	25	98	12	300

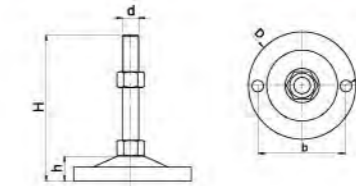

Series	Frame	Wheel	Wheel pitch (mm)	Load(kg)
R28	Aluminum	pp	30, 45	12.5
R28E	Steel, Z/P	pp	33	12.5

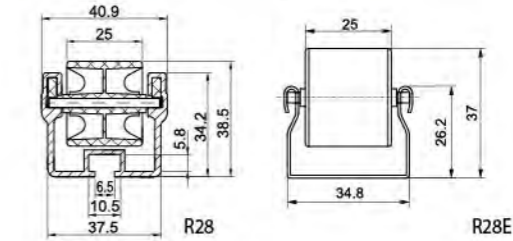

Transfer Ball



WA-01-A

WC-02

Series	Body & Surface	Ball material	Static load(kg)	Dynamic load(kg)
WA-01-A	Steel, Zinc-plated	Q235	25	30
WC-02	Steel, Zinc-plated	Q235	40	50

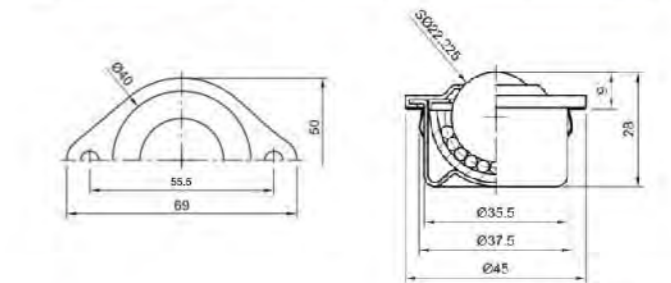

Skate Wheel



GD-01A

GB-02A

Series	Material	d	D	W	W1	Static load (kg)	Dynamic load (kg)
GD-01A	POM+PA6	Φ8.3	Φ50.5	16.5	20.5	8	10
GB-02A	Steel, Z/P	Φ8.1	Φ49	14.5	20.6	8	15

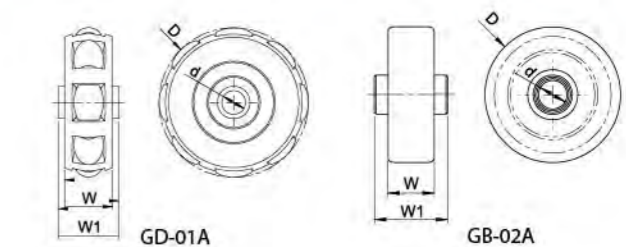

DC24V MDR (PULSEROLLER)--Senergy Series



Idler side



- Imported core component
- High efficiency, high torque
- Wide speed range, convenient control
- Safe, low noise, more intelligent

Light and middle duty application
(Main for Carton & Plastic Box Handling):

Motor cable side

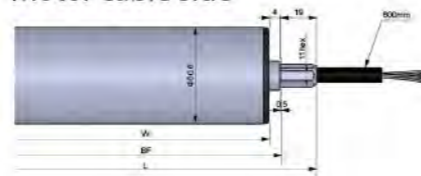

Diameter	ECO-mode								BOOST-mode							
	Speed	Torque (N·m)		Tangential force (N)		Current (A)		Speed	Torque (N·m)		Tangential force (N)		Current (A)			
Φ50mm	(m/min)	Rated	Starting	Rated	Starting	Rated (max)	Starting	(m/min)	Rated	Starting	Rated	Starting	Rated (max)	Starting		
Speed code	Gearbox															
15	Reinforced 3 stage	2.0 - 20.4	2.97	16.39	117.39			2.0 - 14.9	5.40	21.37	213.44	844.86				
20		2.8 - 28.0	2.17	12.00	85.87			2.8 - 20.2	3.95	15.64	156.23	618.38				
25		3.4 - 34.1	1.78	9.83	70.36	388.74			3.4 - 24.7	3.24	12.82	128.06	506.92			
35	2 stage	5.1 - 50.4	1.20	6.66	47.73	263.44			5.1 - 36.5	2.19	8.69	86.759	343.58			
45		6.2 - 61.4	0.99	5.46	39.13	215.91			6.2 - 44.5	1.80	7.12	71.146	281.62			
60		8.4 - 84.0	0.72	4.00	28.56	158.10	2.5	3.0	8.4 - 60.8	1.31	5.21	52.075	206.13	3.5	5.0	
75	1 stage	10.2 - 102.4	0.59	3.27	23.42	129.55			10.2 - 74.2	1.08	4.27	42.688	168.97			
95		13.6 - 135.2	0.44	2.48	17.69	98.12			13.6 - 98.0	0.81	3.23	32.312	127.96			
125		18.4 - 184.4	0.33	1.82	13.04	71.94			18.4 - 133.5	0.60	2.37	23.715	93.874			
175		25.2 - 251.9	0.24	1.33	9.49	52.67			25.2 - 182.5	0.43	1.73	17.292	68.676			
215		30.8 - 307.3	0.19	1.09	7.81	43.18			30.8 - 222.5	0.36	1.42	14.229	56.324			

Remark: We also can provide the pulseroller with the diameter of Φ48.6mm, Φ57mm or Φ60.5mm.

We also can provide taper PULSEROLLER, the specifications can refer to Taper conveyor roller series from page 08-10

Heavy duty application
(Main for Pallet Handling):

Speed code	Driver card	Tube Dia: Φ60.5mm			Tube Dia: Φ76.3mm			Current (A)	
		Speed (m/min)	Starting Torque (N·m)	Capable maximumload	Speed (m/min)	Starting Torque (N·m)	Capable maximumload	Rated (max)	Starting
8	EZ-24HTB	2.5 - 8.1	1950.9	1400kg	3.1 - 10.2	1546.9	1100kg	3.3	7.0
10		3.4 - 11.1	1428.1	1050kg	4.3 - 14	1132.3	850kg		
15		4.7 - 15.1	1045.3	750kg	5.9 - 19.1	828.9	600kg		
20		6.9 - 22.5	702.3	550kg	8.7 - 28.4	556.9	450kg		
25		8.4 - 27.5	575.7	450kg	10.7 - 34.6	456.4	350kg		

Remark: PulseRoller for 1 zone, based on Wood pallet, 9 idlers interlocked by chain, able to handle up to 1400kg pallet.

Standard sprocket conditions: double steel sprocket 10A-13T.

E-Qube Standard: Drive Card



- Run/Stop, CW/CCW
- Dip Switch and Remote adjust speed
- Set Acceleration/Deceleration
- Small volume, Space-saving, Dynamic braking
- Over-Current, Over-Heat protect
- LED Indication

EZ-24 Standard type: Drive card



- Have all the functions of basic type
- More speed regulation
- Support Eco & Boost operating mode
- Sensor signal output function
- Four electronic braking modes

ZP-S1 ZPA type: Drive card



- Built-in intelligent logic, realize the zero pressure accumulation without PLC
- Provide patterns of single or train release
- Plug and play, save time
- Fully compatible with the standard type

ConveyLinx: Drive Card



- Drives two MDRS
- Look ahead, Flex function
- Automatic Data Tracking, Jam Error detected
- Save information with Restore function
- Sensor signal feedback for diagnostic and control
- Ethernet network with ProfiNET, Ethernet IP and Modbus TCP supported
- Simplify procedures, save material and reduce the comprehensive cost